

**MMI**

---

**WAFER, HOUSING & TERMINAL  
PITCH: 4.20x4.20mm**

---

## TERMINAL- MCq 001 (MALE)

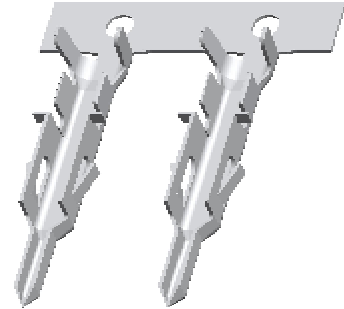
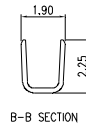
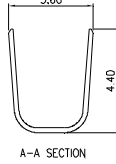
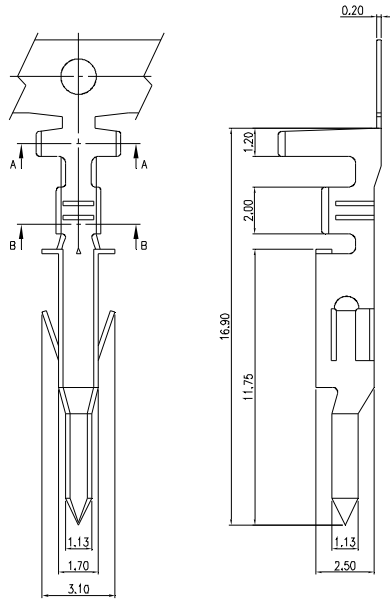

WIRE RANGE: AWG #18 - #22  
 MATERIAL: BRASS  
 FINISH: TIN PLATED  
 INSULATION O.D.: 2.80mm

## TERMINAL- MCq 001 (FEMALE)

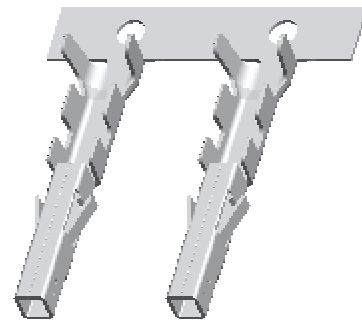
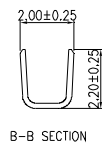
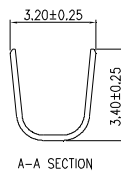
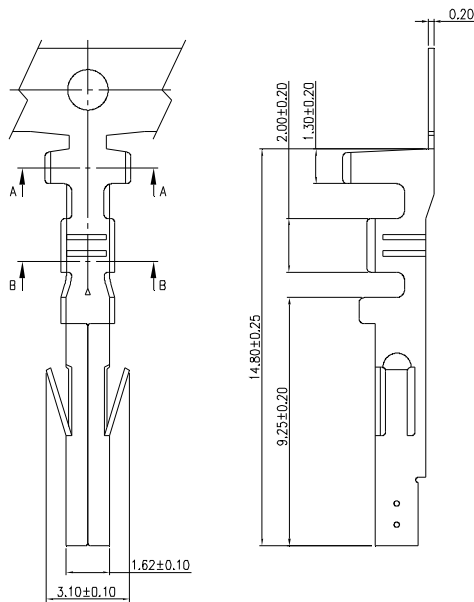

WIRE RANGE: AWG #18 - #22  
 MATERIAL: BRASS  
 FINISH: TIN PLATED  
 INSULATION O.D.: 2.80mm

NOTE : SOME SIZES, STYLES AND OPTION ARE NON-STANDARD, NON-CANCELLABLE, NON-RETURNABLE

## 4.20 X 4.20 mm WAFER - MCq 001 STRAIGHT TYPE - P

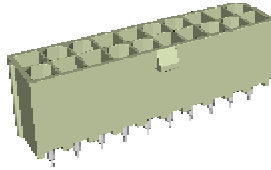
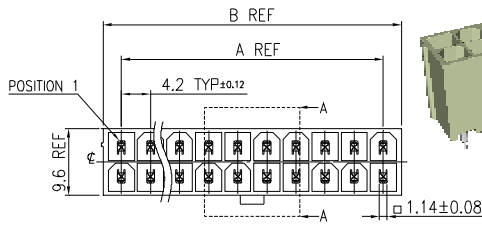

### SPECIFICATIONS

VOLTAGE RATING: 250V AC MAX.  
 CURRENT RATING: 9 AMP  
 WITHSTAND VOLTAGE: 1500V AC/MINUTE  
 INSULATOR RESISTANCE: 1000M OHM MIN. AT 1000V DC  
 TEMPERATURE RANGE: -40°C ~ +105°C  
 CONTACT RESISTANCE: INITIAL VALUE: 30m OHM MAX.

### MATERIALS

CONTACT: BRASS  
 BASE: POLYAMIDE (UL 94V-0, UL 94V-2) NATURE

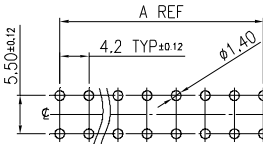
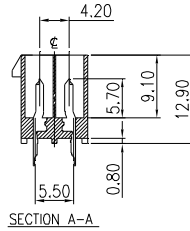
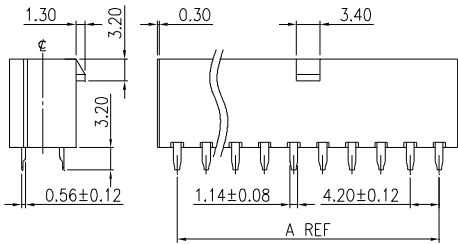

MATING CONNECTOR	
PRODUCT	PART NO.
HOUSING	MCq001-__02-HF
TERMINAL	MCq001-TF

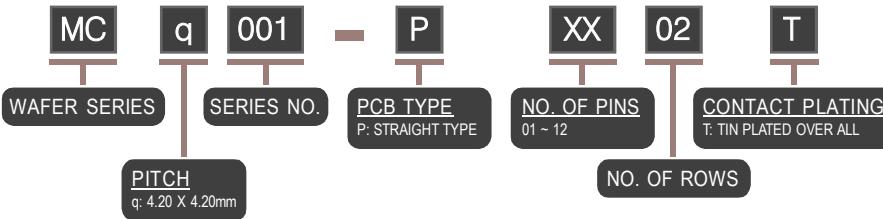

PART NO.	CIRCUITS	DIMENSION	
		A	B
MCq001-P0102T	2X1	--	5.60
MCp001-P0202T	2X2	4.20	9.80
MCp001-P0302T	2X3	8.40	14.00
MCp001-P0402T	2X4	12.60	18.20
MCp001-P0502T	2X5	16.80	22.40
MCp001-P0602T	2X6	21.00	26.60
MCp001-P0702T	2X7	25.20	30.80
MCp001-P0802T	2X8	29.40	35.00
MCp001-P0902T	2X9	33.60	39.20
MCp001-P1002T	2X10	37.80	43.40
MCp001-P1102T	2X11	42.00	47.60
MCp001-P1202T	2X12	46.20	51.80

## 4.20 X 4.20 mm WAFER - MCq 001 STRAIGHT TYPE - P (WITH PLASTIC PEG)

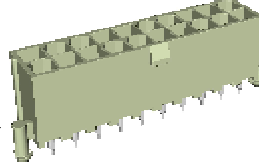
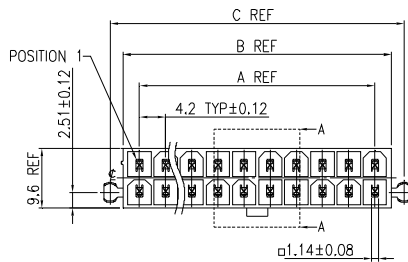

MATING CONNECTOR	
PRODUCT	PART NO.
HOUSING	MCq001-__02-HF
TERMINAL	MCq001-TF

### SPECIFICATIONS

VOLTAGE RATING: 250V AC MAX.  
 CURRENT RATING: 9 AMP  
 WITHSTAND VOLTAGE: 1500V AC/MINUTE  
 INSULATOR RESISTANCE: 1000M OHM MIN. AT 1000V DC  
 TEMPERATURE RANGE: -25°C ~ +85°C  
 CONTACT RESISTANCE: 20m OHM MAX.

### MATERIALS

CONTACT: BRASS  
 INSULATOR: GLASS REINFORCED THERMOPLASTIC  
 PA66 UL 94V-0, COLOR - IVORT,  
 PA66 UL 94V-2, COLOR - NATURE,  
 PA66 UL 94V-2, COLOR - GREEN (HI - TEMP),  
 PA66 UL 94V-2, COLOR - BLACK (HI - TEMP)

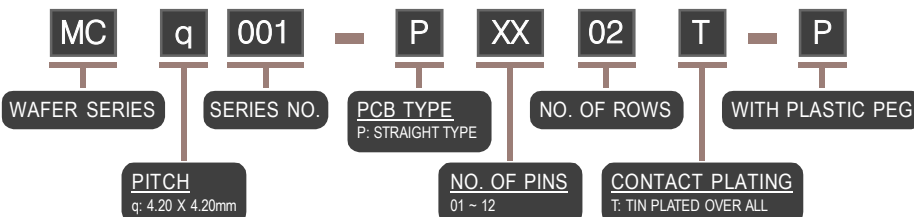
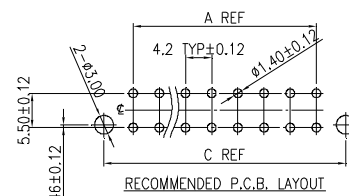
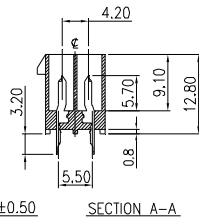
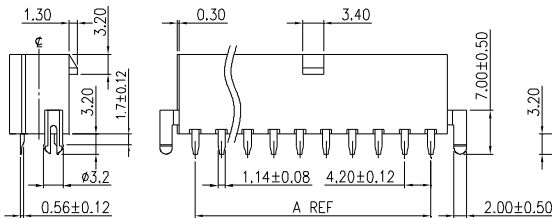

PART NO.	CIRCUITS	DIMENSION		
		A	B	C
MCq001-P0102T-P	2X1	--	5.40	9.40
MCq001-P0202T-P	2X2	4.20	9.60	13.60
MCq001-P0302T-P	2X3	8.40	13.80	17.80
MCq001-P0402T-P	2X4	12.60	18.00	22.00
MCq001-P0502T-P	2X5	16.80	22.20	26.20
MCq001-P0602T-P	2X6	21.00	26.40	30.40
MCq001-P0702T-P	2X7	25.20	30.60	34.60
MCq001-P0802T-P	2X8	29.40	34.80	38.80
MCq001-P0902T-P	2X9	33.60	39.00	43.00
MCq001-P1002T-P	2X10	37.80	43.20	47.20
MCq001-P1102T-P	2X11	42.00	47.40	51.40
MCq001-P1202T-P	2X12	46.20	51.60	55.60

NOTE : SOME SIZES, STYLES AND OPTION ARE NON-STANDARD, NON-CANCELLABLE, NON-RETURNABLE

## 4.20 X 4.20 mm WAFER - MCq 001 STRAIGHT TYPE - P (WITH FLANGES)

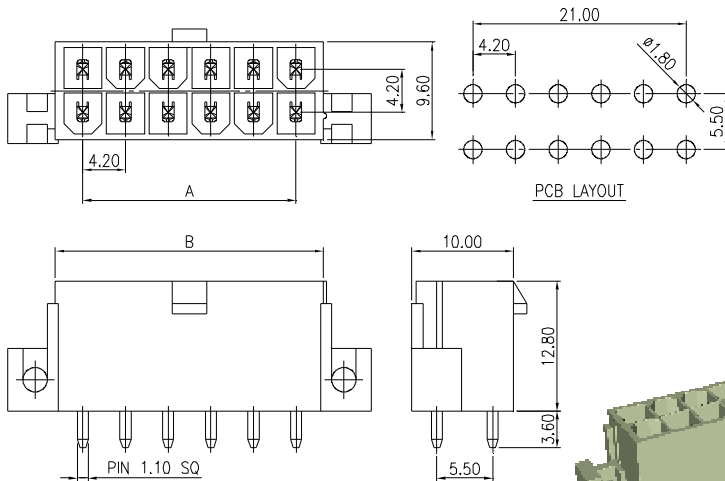

### SPECIFICATIONS

VOLTAGE RATING: 250V AC MAX.  
 CURRENT RATING: 7 AC, DC  
 WITHSTAND VOLTAGE: 1500V AC/MINUTE  
 INSULATOR RESISTANCE: 1000M OHM MIN. AT 1000V DC  
 TEMPERATURE RANGE: -25°C ~ +85°C  
 CONTACT RESISTANCE: 10m OHM MAX.

### MATERIALS

CONTACT: BRASS, TIN PLATED  
 INSULATOR: NYLON 66, UL 94V-0

### MATING CONNECTOR

PRODUCT	PART NO.
HOUSING	MCq001-__02-HF
TERMINAL	MCq001-TF

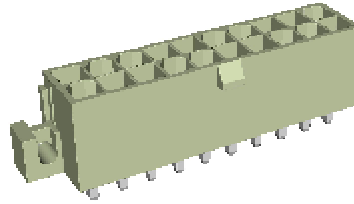

PART NO.	CIRCUITS	DIMENSION	
		A	B
MCq001-P0102T-F	2X1	--	5.60
MCq001-P0202T-F	2X2	4.20	9.80
MCq001-P0302T-F	2X3	8.40	14.00
MCq001-P0402T-F	2X4	12.60	18.20
MCq001-P0502T-F	2X5	16.80	22.40
MCq001-P0602T-F	2X6	21.00	26.60
MCq001-P0702T-F	2X7	25.20	30.80
MCq001-P0802T-F	2X8	29.40	35.00
MCq001-P0902T-F	2X9	33.60	39.20
MCq001-P1002T-F	2X10	37.80	43.40
MCq001-P1102T-F	2X11	42.00	47.60
MCq001-P1202T-F	2X12	46.20	51.80

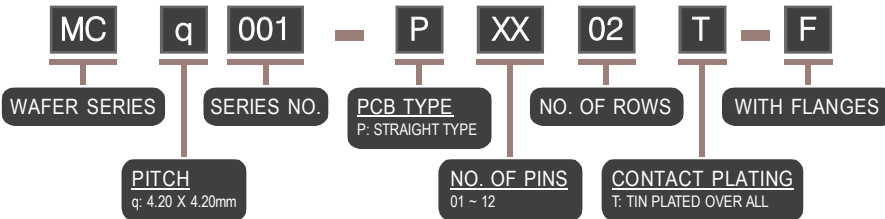

## 4.20 X 4.20 mm WAFER - MCq 001 RIGHT ANGLE TYPE - Pa

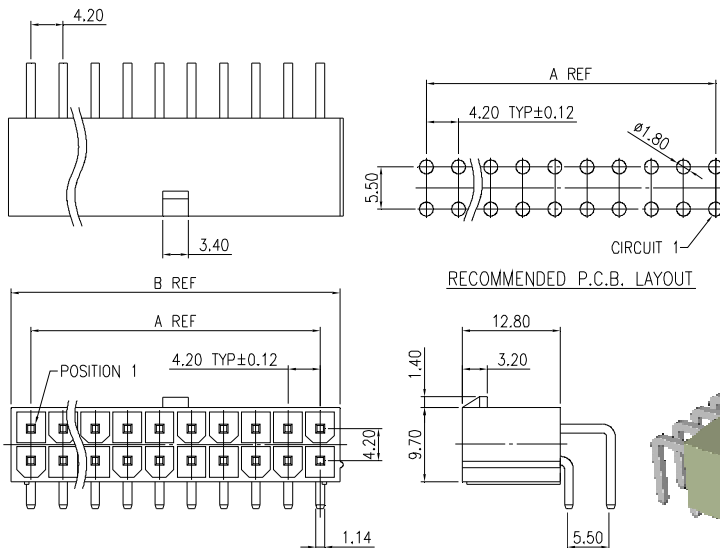

### SPECIFICATIONS

VOLTAGE RATING: 250V AC MAX.  
 CURRENT RATING: 9 AMP  
 WITHSTAND VOLTAGE: 1500V AC/MINUTE  
 INSULATOR RESISTANCE: 1000M OHM MIN. AT 1000V DC  
 TEMPERATURE RANGE: -40°C ~ +105°C  
 CONTACT RESISTANCE: 30m OHM MAX.

### MATERIALS

CONTACT: BRASS  
 BASE: POLYAMIDE (UL 94V-0, UL 94V-2) NATURE

### MATING CONNECTOR

PRODUCT	PART NO.
HOUSING	MCq001-__02-HF
TERMINAL	MCq001-TF

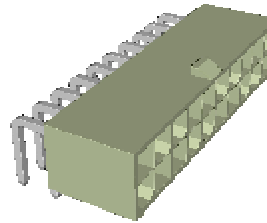

PART NO.	CIRCUITS	DIMENSION	
		A	B
MCq001-Pa0102T	2X1	--	5.60
MCq001-Pa0202T	2X2	4.20	9.80
MCq001-Pa0302T	2X3	8.40	14.00
MCq001-Pa0402T	2X4	12.60	18.20
MCq001-Pa0502T	2X5	16.80	22.40
MCq001-Pa0602T	2X6	21.00	26.60
MCq001-Pa0702T	2X7	25.20	30.80
MCq001-Pa0802T	2X8	29.40	35.00
MCq001-Pa0902T	2X9	33.60	39.20
MCq001-Pa1002T	2X10	37.80	43.40
MCq001-Pa1102T	2X11	42.00	47.60
MCq001-Pa1202T	2X12	46.20	51.80

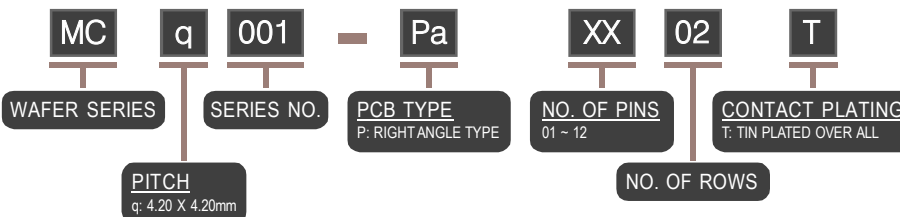

NOTE : SOME SIZES, STYLES AND OPTION ARE NON-STANDARD, NON-CANCELLABLE, NON-RETURNABLE

## 4.20 X 4.20 mm WAFER - MCq 001 RIGHT ANGLE TYPE - Pa (WITH PLASTIC PEG)

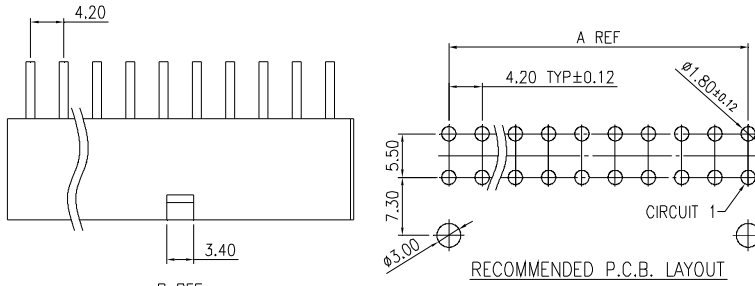

### SPECIFICATIONS

VOLTAGE RATING: 250V AC MAX.  
 CURRENT RATING: 9 AMP  
 WITHSTAND VOLTAGE: 1500V AC/MINUTE  
 INSULATOR RESISTANCE: 1000M OHM MIN. AT 1000V DC  
 TEMPERATURE RANGE: -40°C ~ +105°C  
 CONTACT RESISTANCE: 30m OHM MAX.

### MATERIALS

CONTACT: S.Q. 1.14mm, BRASS  
 BASS: POLYAMIDE (UL 94V-0, UL 94V-2) NATURE

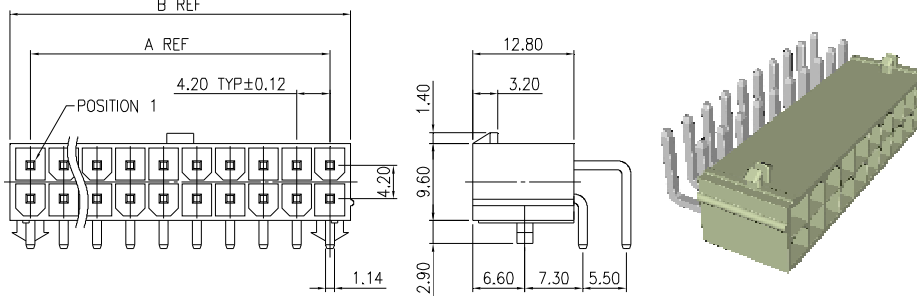

MATING CONNECTOR	
PRODUCT	PART NO.
HOUSING	MCq001-__02-HF
TERMINAL	MCq001-TF

PART NO.	CIRCUITS	DIMENSION	
		A	B
MCq001-Pa0102T-P	2X1	--	5.60
MCq001-Pa0202T-P	2X2	4.20	9.80
MCq001-Pa0302T-P	2X3	8.40	14.00
MCq001-Pa0402T-P	2X4	12.60	18.20
MCq001-Pa0502T-P	2X5	16.80	22.40
MCq001-Pa0602T-P	2X6	21.00	26.60
MCq001-Pa0702T-P	2X7	25.20	30.80
MCq001-Pa0802T-P	2X8	29.40	35.00
MCq001-Pa0902T-P	2X9	33.60	39.20
MCq001-Pa1002T-P	2X10	37.80	43.40
MCq001-Pa1102T-P	2X11	42.00	47.60
MCq001-Pa1202T-P	2X12	46.20	51.80

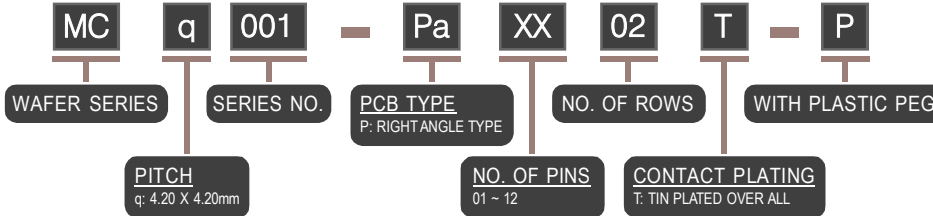

## 4.20 X 4.20 mm WAFER - MCq 001 RIGHT ANGLE TYPE - Pa (WITH FLANGES)

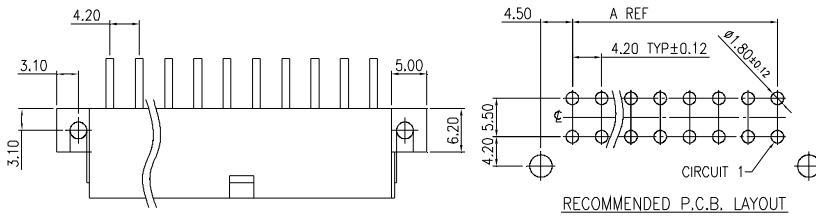

### SPECIFICATIONS

VOLTAGE RATING: 600V AC MAX.  
 CURRENT RATING: 7 AC, DC  
 WITHSTAND VOLTAGE: 1500V AC/MINUTE  
 INSULATOR RESISTANCE: 1000M OHM MIN  
 TEMPERATURE RANGE: -40°C ~ +105°C  
 CONTACT RESISTANCE: 20m OHM MAX.

### MATERIALS

CONTACT: BRASS, TIN PLATED  
 INSULATOR: NYLON 66, UL 94V-2

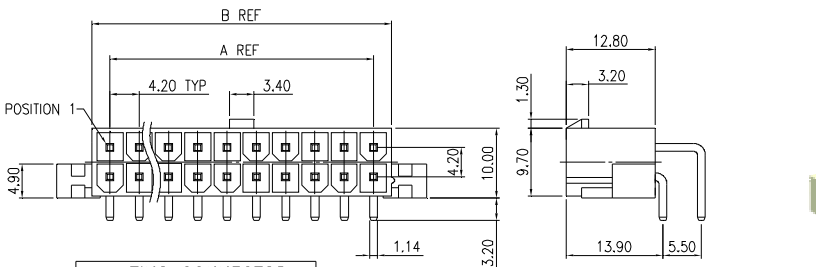

MATING CONNECTOR	
PRODUCT	PART NO.
HOUSING	MCq001-__02-HF
TERMINAL	MCq001-TF

PART NO.	CIRCUITS	DIMENSION	
		A	B
MCq001-Pa0102T-F	2X1	--	5.60
MCq001-Pa0202T-F	2X2	4.20	9.80
MCq001-Pa0302T-F	2X3	8.40	14.00
MCq001-Pa0402T-F	2X4	12.60	18.20
MCq001-Pa0502T-F	2X5	16.80	22.40
MCq001-Pa0602T-F	2X6	21.00	26.60
MCq001-Pa0702T-F	2X7	25.20	30.80
MCq001-Pa0802T-F	2X8	29.40	35.00
MCq001-Pa0902T-F	2X9	33.60	39.20
MCq001-Pa1002T-F	2X10	37.80	43.40
MCq001-Pa1102T-F	2X11	42.00	47.60
MCq001-Pa1202T-F	2X12	46.20	51.80

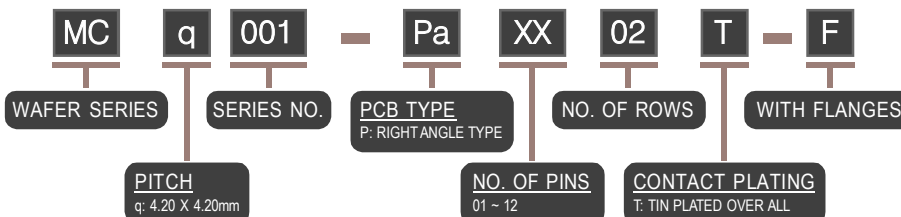

NOTE : SOME SIZES, STYLES AND OPTION ARE NON-STANDARD, NON-CANCELLABLE, NON-RETURNABLE

## 4.20 X 4.20 mm WAFER - MCq 001 RIGHT ANGLE TYPE - Pa (NYLON 66 UL94V-0)

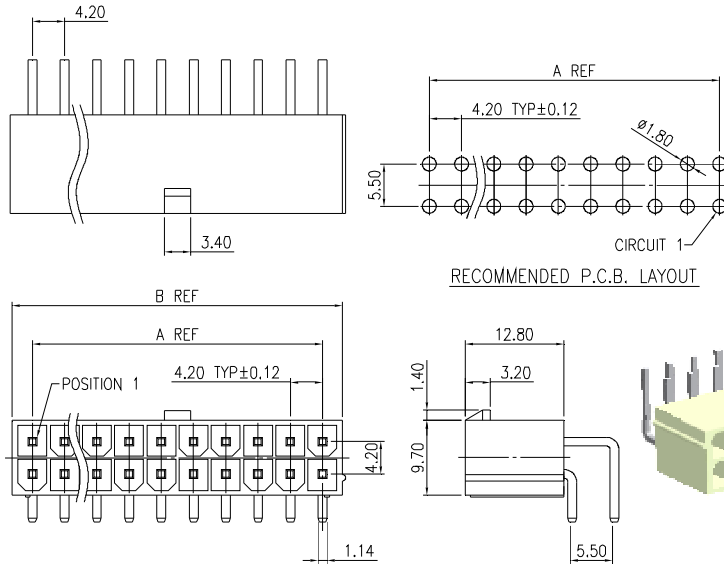

### SPECIFICATIONS

VOLTAGE RATING: 600V AC MAX.  
 CURRENT RATING: 7A, AC/DC  
 WITHSTAND VOLTAGE: 1500V AC/MINUTE  
 INSULATOR RESISTANCE: 1000M OHM MIN.  
 TEMPERATURE RANGE: -40°C ~ +105°C  
 CONTACT RESISTANCE: 20m OHM MAX.

### MATERIALS

CONTACT: BRASS, TIN PLATED  
 BASE: NYLON 66, UL 94V-0

RECOMMENDED P.C.B. LAYOUT

### MATING CONNECTOR

PRODUCT	PART NO.
HOUSING	MCq001-__02-HF
TERMINAL	MCq001-TF

PART NO.	CIRCUITS	DIMENSION	
		A	B
MCq001-Pa0102T	2X1	--	5.60
MCq001-Pa0202T	2X2	4.20	9.80
MCq001-Pa0302T	2X3	8.40	14.00
MCq001-Pa0402T	2X4	12.60	18.20
MCq001-Pa0502T	2X5	16.80	22.40
MCq001-Pa0602T	2X6	21.00	26.60
MCq001-Pa0702T	2X7	25.20	30.80
MCq001-Pa0802T	2X8	29.40	35.00
MCq001-Pa0902T	2X9	33.60	39.20
MCq001-Pa1002T	2X10	37.80	43.40
MCq001-Pa1102T	2X11	42.00	47.60
MCq001-Pa1202T	2X12	46.20	51.80

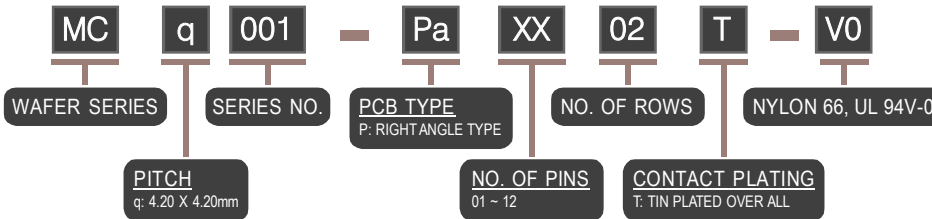

## 4.20 X 4.20 mm WAFER - MCq 002 STRAIGHT TYPE - P (WITH PLASTIC PEG)

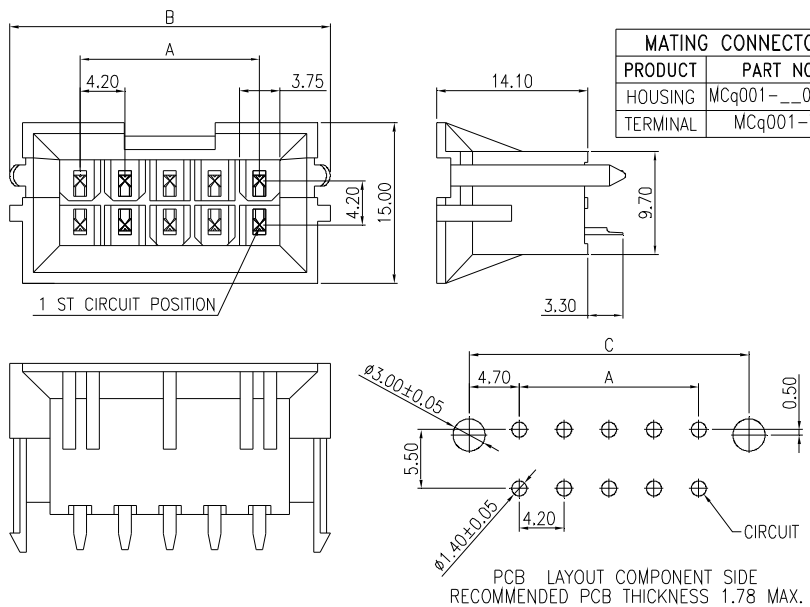

MATING CONNECTOR	
PRODUCT	PART NO.
HOUSING	MCq001-__02-HF
TERMINAL	MCq001-TF

### SPECIFICATIONS

VOLTAGE RATING: 600V AC MAX.  
 CURRENT RATING: 9 AMP  
 WITHSTAND VOLTAGE: 1500V AC/MINUTE  
 INSULATOR RESISTANCE: 1000M OHM MIN.  
 TEMPERATURE RANGE: -40°C ~ +105°C  
 CONTACT RESISTANCE: 10m OHM MAX.

### MATERIALS

CONTACT: BRASS, TIN PLATED  
 INSULATOR: NYLON 66, UL 94V-0

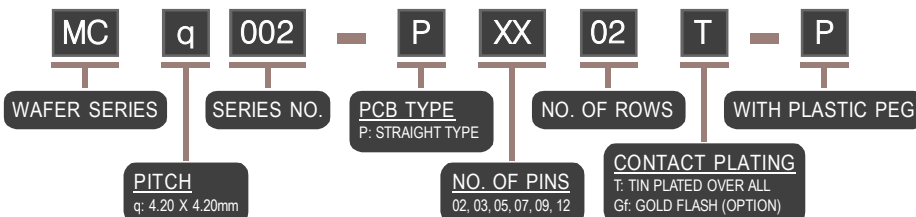
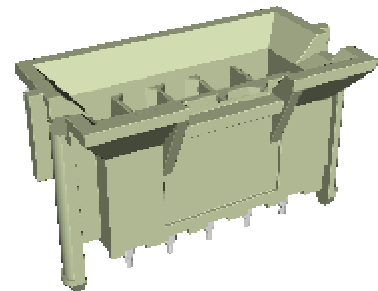

PART NO.	CIRCUITS	DIMENSION		
		A	B	C
MCq002-P0202T-P	2X2	4.20	17.40	13.60
MCq002-P0302T-P	2X3	8.40	21.60	17.80
MCq002-P0502T-P	2X5	16.80	30.00	26.20
MCq002-P0702T-P	2X7	25.20	38.40	34.60
MCq002-P0902T-P	2X9	33.60	46.80	43.00
MCq002-P1202T-P	2X12	42.00	59.40	55.60

NOTE: SOME SIZES, STYLES AND OPTION ARE NON-STANDARD, NON-CANCELLABLE, NON-RETURNABLE

## 4.20 X 4.20 mm WAFER - MCq 002 RIGHT ANGLE TYPE - Pa (WITH PLASTIC PEG)

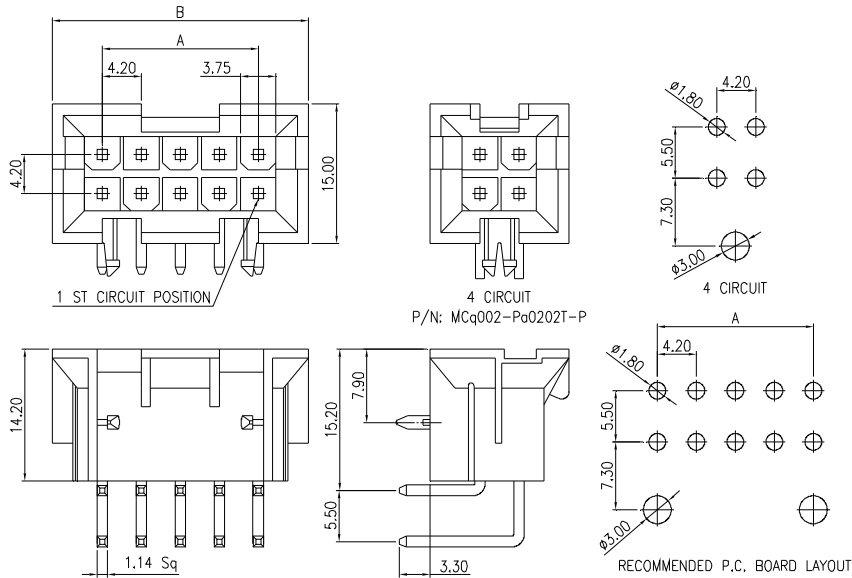

### MATERIALS

CONTACT: BRASS, TIN OVER NICKEL  
BASS: NYLON 66

### MATING CONNECTOR

PRODUCT	PART NO.
HOUSING	MCq001-__02-HF
TERMINAL	MCq001-TF

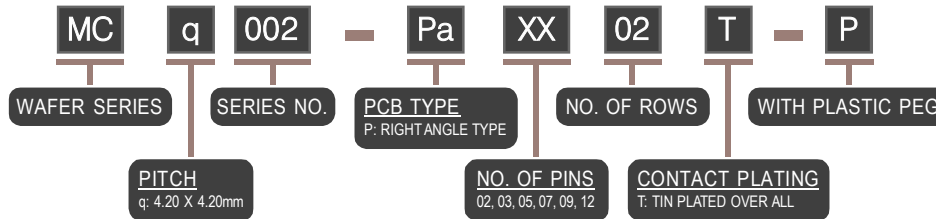

PART NO.	CIRCUITS	DIMENSION	
		A	B
MCq002-Pa0202T-P	2X2	4.20	15.20
MCq002-Pa0302T-P	2X3	8.40	19.40
MCq002-Pa0502T-P	2X5	16.80	27.80
MCq002-Pa0702T-P	2X7	25.20	36.20
MCq002-Pa0902T-P	2X9	33.60	44.60
MCq002-Pa1202T-P	2X12	46.20	57.20

## 4.20 X 4.20 mm WAFER - MCq 004 STRAIGHT TYPE - P

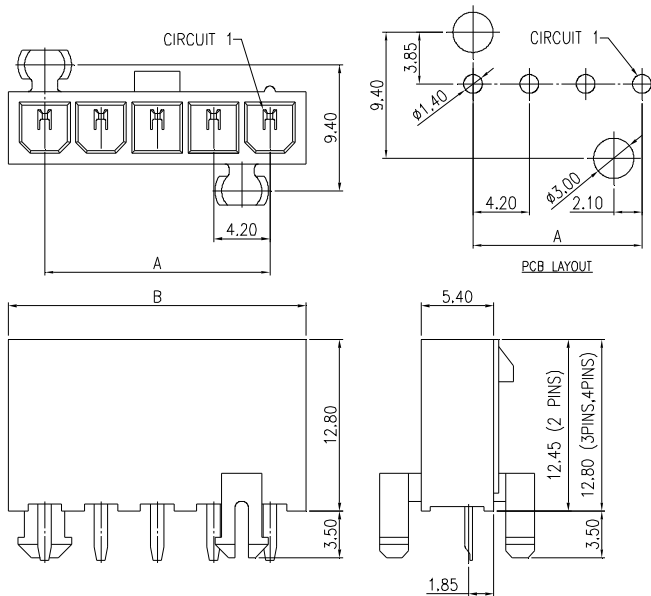

### SPECIFICATIONS

VOLTAGE RATING: 250V AC MAX.  
CURRENT RATING: 7 A AC/DC  
WITHSTAND VOLTAGE: 1500V AC/MINUTE  
INSULATOR RESISTANCE: 1000M OHM MIN.  
TEMPERATURE RANGE: -25°C ~ +85°C  
CONTACT RESISTANCE: 10m OHM MAX.

### MATERIALS

CONTACT: BRASS, TIN PLATED  
BASE: NYLON 66, UL 94V-2

### MATING CONNECTOR

PRODUCT	PART NO.
TERMINAL	MCq001-TF

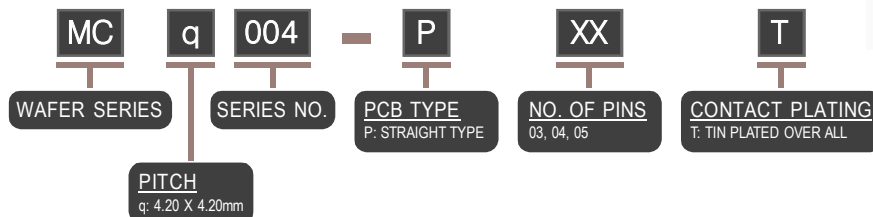

PART NO.	CIRCUITS	DIMENSION	
		A	B
MCp004-P03T	3	8.40	13.80
MCp004-P04T	4	12.60	18.00
MCp004-P05T	5	16.80	22.20

NOTE : SOME SIZES, STYLES AND OPTION ARE NON-STANDARD, NON-CANCELLABLE, NON-RETURNABLE

## 4.20 X 4.20 mm WAFER - MCq 005 RIGHT ANGLE TYPE - Pa (WITH PLASTIC PEG)

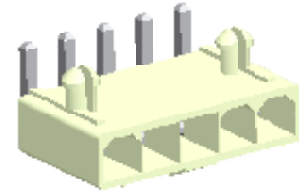
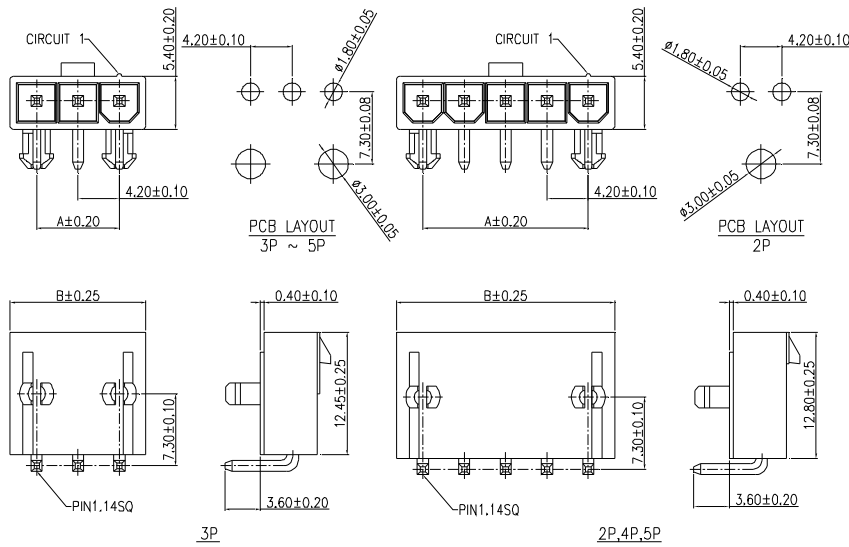

### SPECIFICATIONS

VOLTAGE RATING: 250V AC MAX.  
CURRENT RATING: 7A AC/DC  
WITHSTAND VOLTAGE: 1500V AC/MINUTE  
INSULATOR RESISTANCE: 1000M OHM MIN.  
TEMPERATURE RANGE: -25°C ~ +85°C  
CONTACT RESISTANCE: 10m OHM MAX.

### MATERIALS

CONTACT: BRASS, TIN PLATED  
BASS: NYLON 66, UL 94V-2

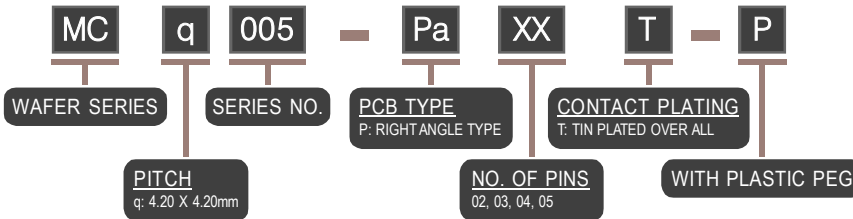

PART NO.	CIRCUITS	DIMENSION	
		A	B
MCq005-Pa02T-P	2	4.20	9.60
MCq005-Pa03T-P	3	8.40	13.80
MCq005-Pa04T-P	4	12.60	18.00
MCq005-Pa05T-P	5	16.80	22.20

## 4.20 X 4.20 mm WAFER - MCq 006 RIGHT ANGLE TYPE - Pa (WITH FLANGES)

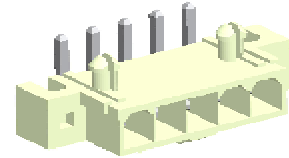
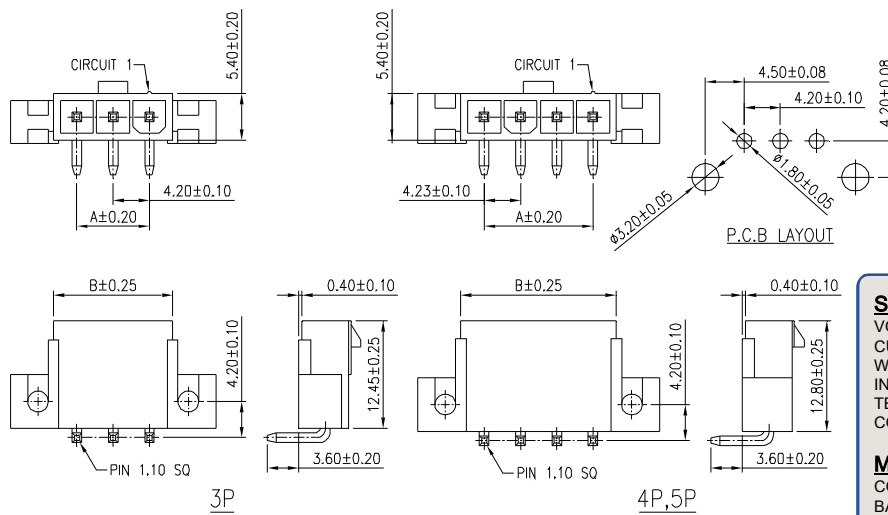

### SPECIFICATIONS

VOLTAGE RATING: 250V AC MAX.  
CURRENT RATING: 7A AC/DC  
WITHSTAND VOLTAGE: 1500V AC/MINUTE  
INSULATOR RESISTANCE: 1000M OHM MIN.  
TEMPERATURE RANGE: -25°C ~ +85°C  
CONTACT RESISTANCE: 10m OHM MAX.

### MATERIALS

CONTACT: BRASS, TIN PLATED  
BASS: NYLON 66, UL 94V-2

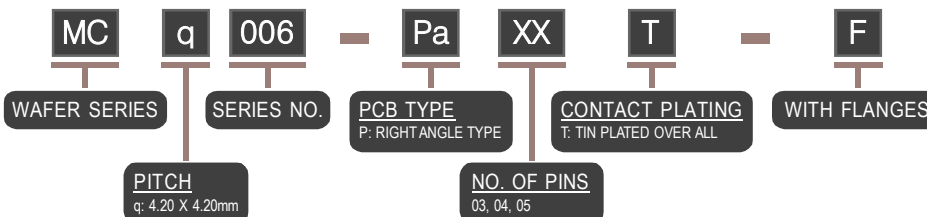

PART NO.	CIRCUITS	DIMENSION	
		A	B
MCq006-Pa03T-P	3	8.40	13.80
MCq006-Pa04T-P	4	12.60	18.00
MCq006-Pa05T-P	5	16.80	22.20

NOTE : SOME SIZES, STYLES AND OPTION ARE NON-STANDARD, NON-CANCELLABLE, NON-RETURNABLE



# 4.20 X 4.20 mm WAFER - MCq 012 STRAIGHT TYPE - P

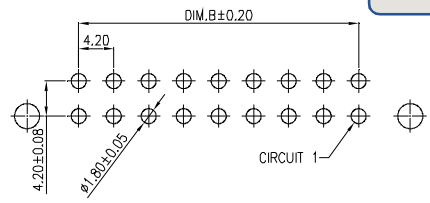
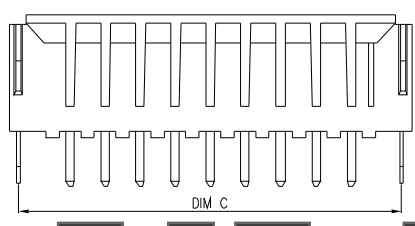
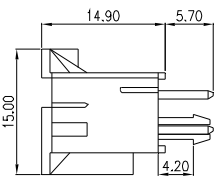
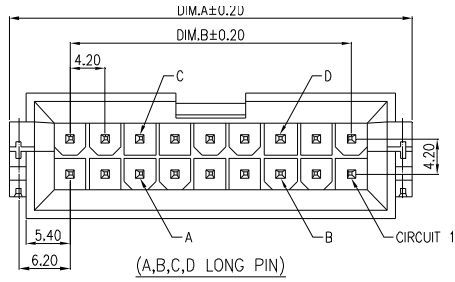

PCB LAYOUT COMPONENT SIDE  
RECOMMENDED PCB THICKNESS 1.78 MAX

**SPECIFICATIONS**  
 VOLTAGE RATING: 600V AC/DC  
 CURRENT RATING: 7A AC/DC  
 WITHSTAND VOLTAGE: 1500V AC/MINUTE  
 INSULATOR RESISTANCE: 1000M OHM MIN  
 TEMPERATURE RANGE: -40°C ~ +105°C  
 CONTACT RESISTANCE: INITIAL VALUE 10m OHM MAX.

**MATERIALS**  
 BASE: NYLON 46, UL94V-0  
 CONTACT: BRASS OR PHOSPHOR BRONZE  
 FINISH: TIN, SELECT GOLD

PART NO.	CIRCUITS	DIMENSION		
		A	B	C
MCq012-P020ZG -	2X2	18.81	4.20	16.60
MCq012-P030ZG -	2X3	23.01	8.40	20.80
MCq012-P040ZG -	2X4	27.21	12.60	25.00
MCq012-P050ZG -	2X5	31.41	16.80	29.20
MCq012-P060ZG -	2X6	35.61	21.00	33.40
MCq012-P070ZG -	2X7	39.81	25.20	37.60
MCq012-P080ZG -	2X8	44.01	29.40	41.80
MCq012-P090ZG -	2X9	48.21	33.60	46.00

**MC** **q** **012** - **P** **XX** **02** **GX** - **X**

**WAFER SERIES**      **SERIES NO.**      **PCB TYPE**  
 P: STRAIGHT TYPE

**NO. OF PINS**      **NO. OF ROWS**      **WITH LOCK OPTION**  
 02 - 09      BLANK: WITHOUT LOCK  
 L: WITH LOCK

**PITCH**  
 q: 4.20 X 4.20mm

**CONTACT PLATING**  
 T: TIN PLATED  
 Gf: GOLD FLASH  
 Gf: GOLD FLASH ON CONTACT, TIN PLATED ON SOLDER TAIL  
 G15t: 15µ" GOLD ON CONTACT, TIN PLATED ON SOLDER TAIL  
 G30t: 30µ" GOLD ON CONTACT, TIN PLATED ON SOLDER TAIL

NOTE : SOME SIZES, STYLES AND OPTION ARE NON-STANDARD, NON-CANCELLABLE, NON-RETURNABLE

## 4.20 X 4.20 mm HOUSING - MCq 001 (MALE)

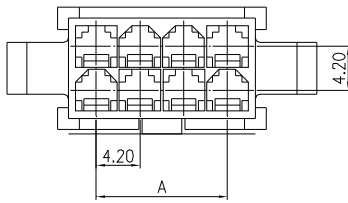

MATING CONNECTOR	
PRODUCT	PART NO.
HOUSING	MCq001-__02-HF
TERMINAL	MCq001-TM

### SPECIFICATIONS

VOLTAGE RATING: 250V AC/DC  
 CURRENT RATING: 7A AC/DC  
 WITHSTAND VOLTAGE: 1500V AC/MINUTE  
 INSULATOR RESISTANCE: 1000M OHM MIN.  
 TEMPERATURE RANGE: -25°C ~ +85°C  
 CONTACT RESISTANCE: 10m OHM MAX.

### MATERIALS

BASE: NYLON 66, UL 94V-2

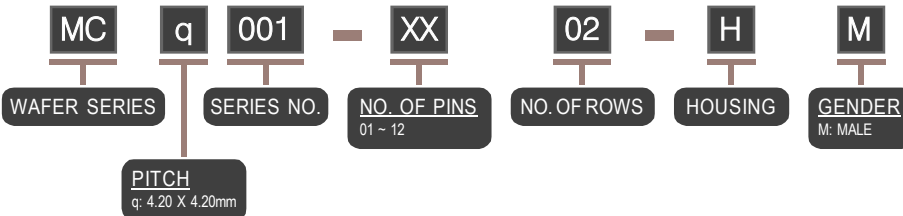
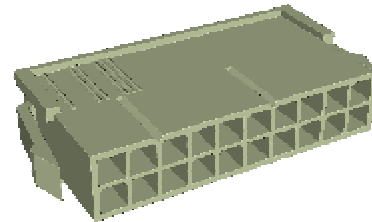
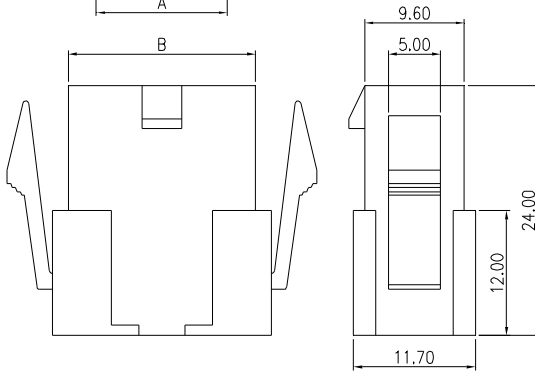

PART NO.	CIRCUITS	DIMENSION	
		A	B
MCq001-0102-HM	2X1	--	5.40
MCq001-0202-HM	2X2	4.20	9.60
MCq001-0302-HM	2X3	8.40	13.80
MCq001-0402-HM	2X4	12.60	18.00
MCq001-0502-HM	2X5	16.80	22.20
MCq001-0602-HM	2X6	21.00	26.40
MCq001-0702-HM	2X7	25.20	30.60
MCq001-0802-HM	2X8	29.40	34.80
MCq001-0902-HM	2X9	33.60	39.00
MCq001-1002-HM	2X10	37.80	43.20
MCq001-1102-HM	2X11	42.00	47.40
MCq001-1202-HM	2X12	46.20	51.60

## 4.20 X 4.20 mm HOUSING - MCq 001 (FEMALE)

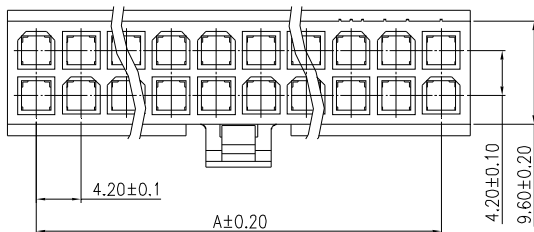

MATING CONNECTOR	
PRODUCT	PART NO.
WAFFER	MCq001 SERIES
HOUSING	MCq001-__02-HM
TERMINAL	MCq001-TF

### SPECIFICATIONS

VOLTAGE RATING: 250V AC/DC  
 CURRENT RATING: 7A AC/DC  
 WITHSTAND VOLTAGE: 1500V AC/MINUTE  
 INSULATOR RESISTANCE: 1000M OHM MIN.  
 TEMPERATURE RANGE: -25°C ~ +85°C  
 CONTACT RESISTANCE: 10m OHM MAX.

### MATERIALS

BASE: NYLON 66, UL 94V-2

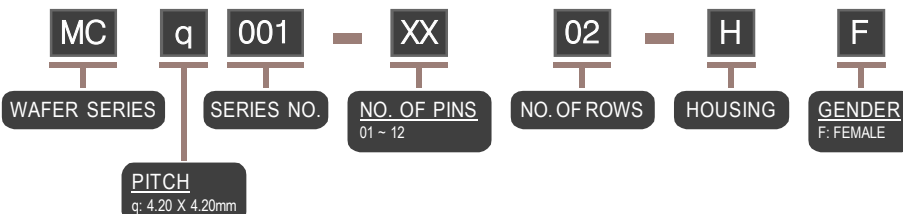
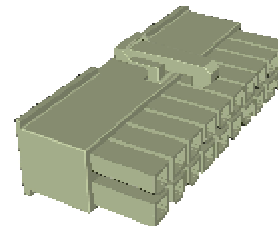
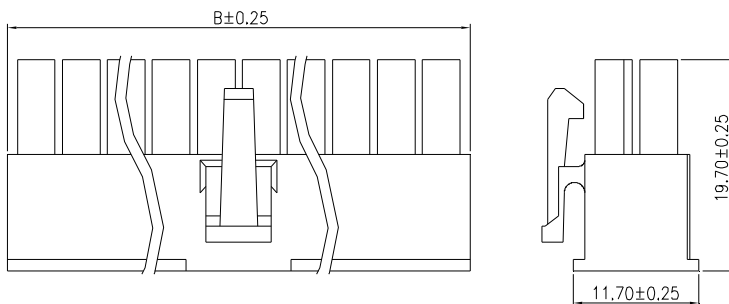

PART NO.	CIRCUITS	DIMENSION	
		A	B
MCq001-0102-HF	2X1	--	5.40
MCq001-0202-HF	2X2	4.20	9.60
MCq001-0302-HF	2X3	8.40	13.80
MCq001-0402-HF	2X4	12.60	18.00
MCq001-0502-HF	2X5	16.80	22.20
MCq001-0602-HF	2X6	21.00	26.40
MCq001-0702-HF	2X7	25.20	30.60
MCq001-0802-HF	2X8	29.40	34.80
MCq001-0902-HF	2X9	33.60	39.00
MCq001-1002-HF	2X10	37.80	43.20
MCq001-1102-HF	2X11	42.00	47.40
MCq001-1202-HF	2X12	46.20	51.60

NOTE : SOME SIZES, STYLES AND OPTION ARE NON-STANDARD, NON-CANCELLABLE, NON-RETURNABLE

# 4.20 X 4.20 mm HOUSING - MCq 003 (MALE)

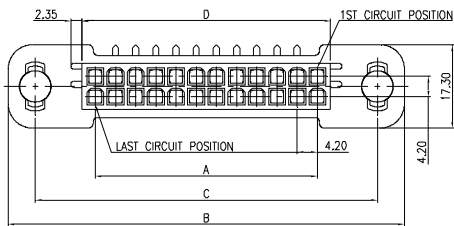

MATING CONNECTOR	
PRODUCT	PART NO.
WAFER	MCq001 SERIES
	MCq002 SEREIS
TERMINAL	MCq001-TF

### MECHANICAL

CONTACT INSERTION FORCE: 1.5Kg MAX.  
 CONTACT RETENTION TO HOUSING: 3.0Kg MIN.  
 WIRE PULL-PUT FORCE: 9.0Kg MIN.  
 MATING FORCE: 0.35kg MIN.  
 NORMAL FORCE: 2g MIN.  
 DURABILITY: 30 CYCLES  
 TEMPERATURE RANGE: -40°C ~ +105°C

### MATERIALS

BASE: NYLON 66, UL 94V-2

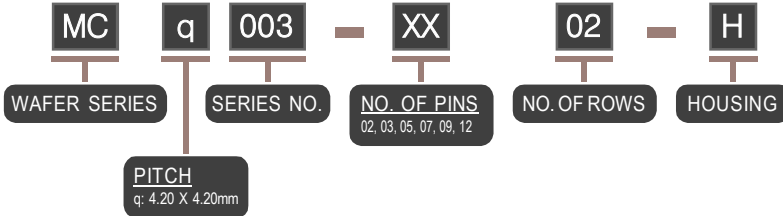
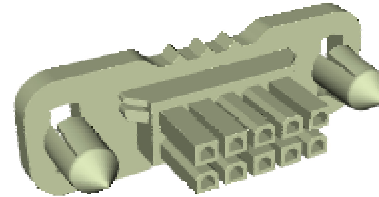
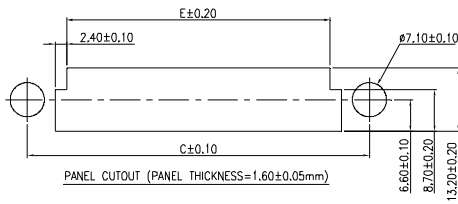
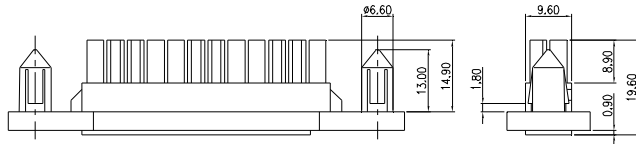

PART NO.	CIRCUITS	DIMENSION				
		A	B	C	D	E
MCq003-0202-H	2X2	4.20	40.40	29.20	9.70	12.80
MCq003-0302-H	2X3	8.40	44.60	33.40	13.90	17.00
MCq003-0502-H	2X5	16.80	53.00	41.80	22.30	25.40
MCq003-0702-H	2X7	25.20	61.40	50.20	30.70	33.80
MCq003-0902-H	2X9	33.60	69.80	58.60	39.10	42.20
MCq003-1202-H	2X12	46.20	82.40	71.20	51.70	54.80

NOTE : SOME SIZES, STYLES AND OPTION ARE NON-STANDARD, NON-CANCELLABLE, NON-RETURNABLE